

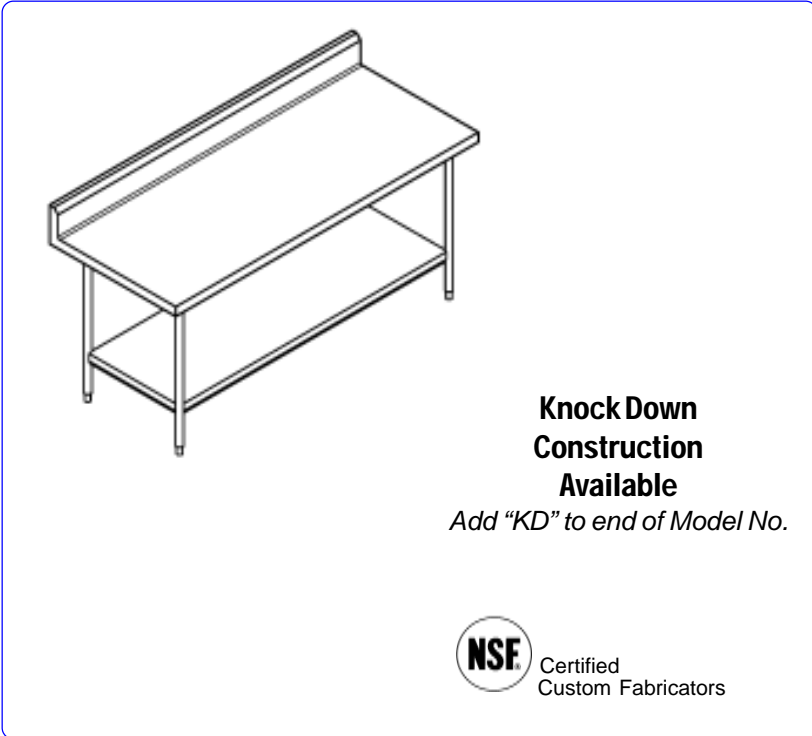

Worktable w/ Undershef & Backsplash



MATERIAL

Top: 14g. or 16g. Stainless Steel, Type 304, #4 Finish

Hat Channel: 16g Galvanized

Undershef: 16g. or 18g. Stainless Steel, Type 304/4

Legs: 1-5/8" O.D. SS 304/4 Tubular Legs, .065 Wall

Stainless Steel Gussets & Adjustable Bullet Feet

CONSTRUCTION

Built in compliance with NSF Standard No.2 and bear the NSF mark of approval.

Top reinforced with welded hat channel.

Sound deadened between top and channel.

6" Backsplash designed to maintain a truly straight backsplash (TSB & TSBC Models.)

1-3/4" **Hemmed** turndown where there is no splash.

Tables 75" and longer come with six legs or more.

OPTIONS

- Bullet Feet w/ Pre Drilled Holes
- Flanged Feet with and without Pre Drilled Holes
- Casters with & without brake
- Additional Undershelves
- Cross Bracing
- Overshelves
- Drawer(s)
- Sink(s)
- Receptacle(s)
- End Splashes
- Marine Edge
- Hipped Edge
- Bullnose Edge
- Round Edge

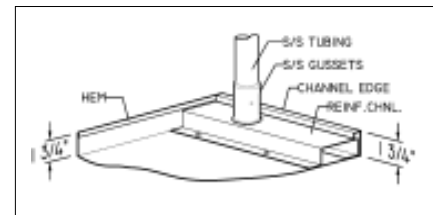

CUSTOM SIZES AVAILABLE

24" WIDE					30" WIDE					36" WIDE					
14g. Top 16g Undershef			16g. Top 18g Undershef		14g. Top 16g Undershef			16g. Top 18g Undershef		14g. Top 16g Undershef			16g. Top 18g Undershef		
O.A. Dim.	Model Number	Ship Wt.	Model Number	Ship Wt.	O.A. Dim.	Model Number	Ship Wt.	Model Number	Ship Wt.	O.A. Dim.	Model Number	Ship Wt.	Model Number	Ship Wt.	Cubic Ft.
36x24	36TSB24-14		36TSB24		36x30	36TSB30-14		36TSB30		36x36	36TSB36-14		36TSB36		
48x24	48TSB24-14		48TSB24		48x30	48TSB30-14		48TSB30		48x36	48TSB36-14		48TSB36		
60x24	60TSB24-14		60TSB24		60x30	60TSB30-14		60TSB30		60x36	60TSB36-14		60TSB36		
72x24	72TSB24-14		72TSB24		72x30	72TSB30-14		72TSB30		72x36	72TSB36-14		72TSB36		
84x24	84TSB24-14		84TSB24		84x30	84TSB30-14		84TSB30		84x36	84TSB36-14		84TSB36		
96x24	96TSB24-14		96TSB24		96x30	96TSB30-14		96TSB30		96x36	96TSB36-14		96TSB36		
108x24	108TSB24-14		108TSB24		108x30	108TSB30-14		108TSB30		108x36	108TSB36-14		108TSB36		
120x24	120TSB24-14		120TSB24		120x30	120TSB30-14		120TSB30		120x36	120TSB36-14		120TSB36		
132x24	132TSB24-14		132TSB24		132x30	132TSB30-14		132TSB30		132x36	132TSB36-14		132TSB36		
144x24	144TSB24-14		144TSB24		144x30	144TSB30-14		144TSB30		144x36	144TSB36-14		144TSB36		

Email: salesandinfo@chainfabricator.com

Phone: (916) 638-7370 or 1-888-300-6196 Fax: (916) 638-1172

2650 Mercantile Dr., Suite C - Rancho Cordova, CA 95742

TS & TSB-3



Worktable w/ Undershaft & Backsplash

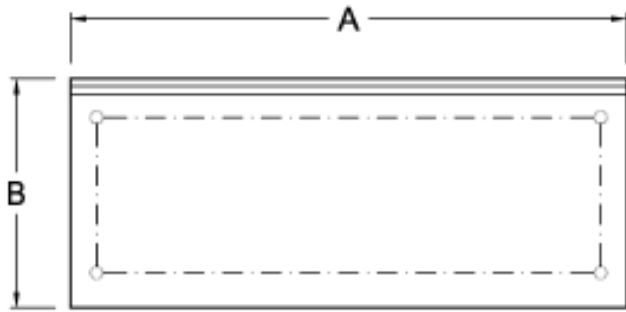

PLAN

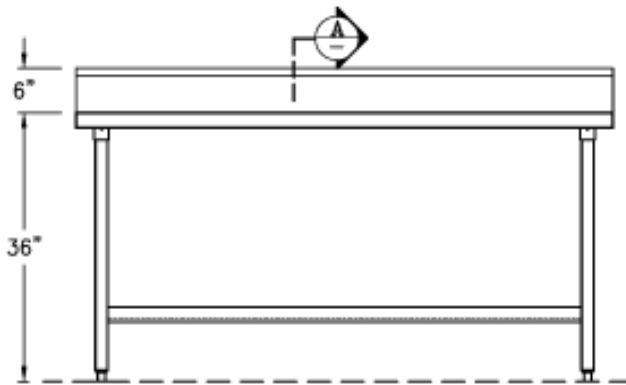

ELEVATION

CUSTOM SIZES AVAILABLE

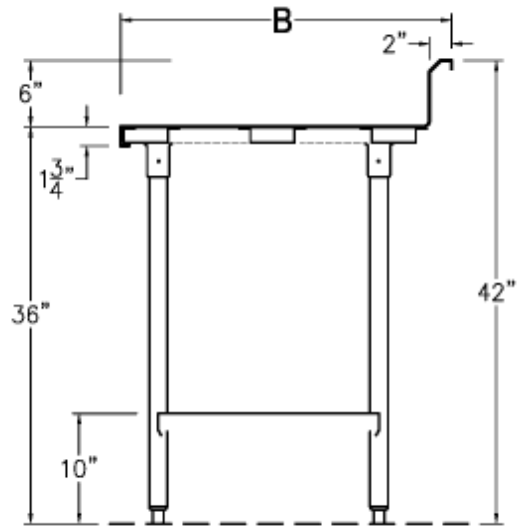

SECTION



24" WIDE

14g. Top 16g. Top
 16g Shelf 18g Shelf

30" WIDE

14g. Top 16g. Top
 16g Shelf 18g Shelf

36" WIDE

14g. Top 16g. Top
 16g Shelf 18g Shelf

O.A. Dim. A	O.A. Dim. B	Model Number	Model Number
36	24	36TSB24-14	36TSB24
48	24	48TSB24-14	48TSB24
60	24	60TSB24-14	60TSB24
72	24	72TSB24-14	72TSB24
84	24	84TSB24-14	84TSB24
96	24	96TSB24-14	96TSB24
108	24	108TSB24-14	108TSB24
120	24	120TSB24-14	120TSB24
132	24	132TSB24-14	132TSB24
144	24	144TSB24-14	144TSB24

O.A. Dim. A	O.A. Dim. B	Model Number	Model Number
36	30	36TSB30-14	36TSB30
48	30	48TSB30-14	48TSB30
60	30	60TSB30-14	60TSB30
72	30	72TSB30-14	72TSB30
84	30	84TSB30-14	84TSB30
96	30	96TSB30-14	96TSB30
108	30	108TSB30-14	108TSB30
120	30	120TSB30-14	120TSB30
132	30	132TSB30-14	132TSB30
144	30	144TSB30-14	144TSB30

O.A. Dim. A	O.A. Dim. B	Model Number	Model Number
36	36	36TSB36-14	36TSB36
48	36	48TSB36-14	48TSB36
60	36	60TSB36-14	60TSB36
72	36	72TSB36-14	72TSB36
84	36	84TSB36-14	84TSB36
96	36	96TSB36-14	96TSB36
108	36	108TSB36-14	108TSB36
120	36	120TSB36-14	120TSB36
132	36	132TSB36-14	132TSB36
144	36	144TSB36-14	144TSB36

Email: salesandinfo@chainfabricator.com

Phone: (916) 638-7370 or 1-888-300-6196 Fax: (916) 638-1172